

791-069 Rear-Panel Mount Hermetic Receptacles, Pin Face Scoop-Proof

HOW TO ORDER	
Sample Part Number	791-069 H D 7P2 C N
Basic Part Number	791-069 Rear-Panel Mount Hermetic Receptacles, Pin Face Scoop-Proof
Class	H = Hermetic
Shell Size	A, B, C, D, E, F, J, K, G, H, L and M
Arrangement	Refer to Pages L-3--L-6 for Insert Arr. (No "W" Option for Hermetic)
Contact Type	C = Pin, P.C. Tail P = Pin, Solder Cup
Mating Hardware Option	N = No Mating Hardware G = Male Guide Pins P = Jackpost S = Female Guide Sockets

MATERIAL AND FINISH

- Shell - Kovar Alloy / Nickel Plate
- Contacts - Kovar Alloy / Gold Plate
- Insulator - Vitreous Glass
- Rear Spacers (Not Shown) - Rigid Dielectric
- Seals - Fluorosilicone Blend
- Mating Hardware - CRES / Passivated

NOTES

Test Criteria:

- Hermeticity - $< 1 \times 10^{-7}$ sccHe/Sec @ 1 Atm. Delta

D.W.V.

- #23 Pins: 500 Vac Pin-To-Shell
- #16 Pins: 1800 Vac Pin-To-Shell
- #12 Pins: 1800 Vac Pin-To-Shell
- # 8 Pins: 1800 Vac Pin-To-Shell
- I.R. - 5,000 Megohms Minimum @ 500 VDC
- Glenair 791-069 will mate with any scoop-proof Series 79 plug with socket contacts and same shell and insert.
- Glenair 791-069 is designed to utilize 799-016 EMI backshells.

Mounting Hardware

P Jackpost	Connector supplied with non-removable jackpost. Shell size "M" has 8-32 UNC-2B thread. Shell sizes "H" And "L" have 6-32 UNC-2B thread. All other sizes Have 4-40 UNC-2B thread.
G Guide Pin	Connector supplied with non-removable guide pins for blind mate applications. Mates with option "S" guide socket on corresponding plug connector.
S Guide Socket	Connector supplied with non-removable guide sockets for blind mate applications. Mates with option "G" guide pin on corresponding plug connector.

SHELL SIZE A, B, C, D, E, F, J, AND K DIMENSIONS

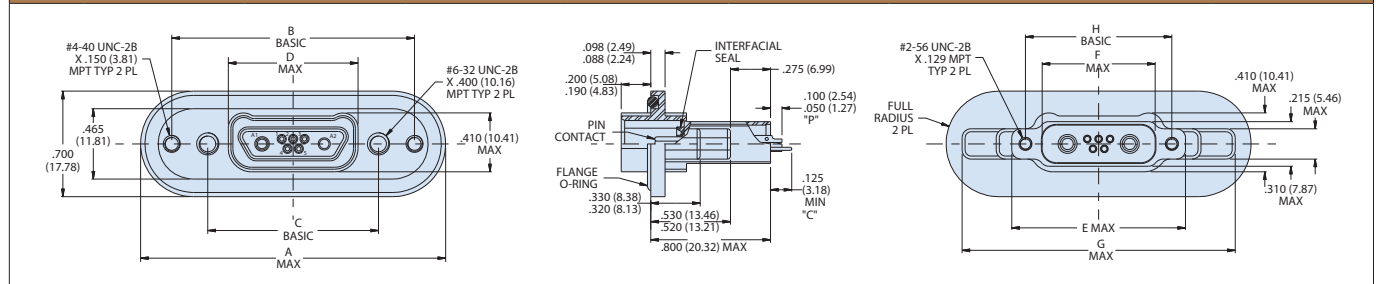

Shell Sizes	A Oal	B Basic	C Basic	D Max	E Max	F Max	G Max	H Max
A	1.750 (44.45)	1.300 (33.02)	0.750 (19.05)	0.490 (12.45)	0.760 (19.30)	0.350 (8.89)	1.500 (38.10)	0.565 (14.35)
B	1.950 (49.53)	1.475 (37.47)	0.900 (22.86)	0.630 (16.00)	0.910 (23.11)	0.500 (12.70)	1.700 (43.18)	0.715 (18.16)
C	2.025 (51.43)	1.600 (40.64)	1.050 (26.67)	0.780 (19.81)	1.060 (26.92)	0.650 (16.51)	1.800 (45.72)	0.865 (21.97)
D	2.125 (53.97)	1.700 (43.18)	1.125 (28.58)	0.860 (21.84)	1.160 (29.46)	0.750 (19.05)	1.900 (48.26)	0.965 (24.51)
E	2.325 (59.06)	1.800 (45.72)	1.275 (32.39)	1.010 (25.65)	1.310 (33.27)	0.900 (22.86)	2.100 (53.34)	1.115 (28.32)
F	2.325 (59.06)	1.925 (48.90)	1.425 (36.20)	1.160 (29.46)	1.460 (37.08)	1.050 (26.67)	2.100 (53.34)	1.265 (32.13)
J	2.915 (74.04)	2.400 (60.96)	1.800 (45.72)	1.530 (38.86)	1.810 (45.97)	1.405 (35.69)	2.650 (67.31)	1.615 (41.02)
K	3.110 (78.99)	2.675 (67.94)	2.175 (55.24)	1.910 (48.51)	2.210 (56.13)	1.805 (45.85)	2.900 (73.66)	2.015 (51.18)

SERIES 79

MICRO-CRIMP



791-069 Rear-Panel Mount Hermetic Receptacles, Pin Face Scoop-Proof

SHELL SIZE G

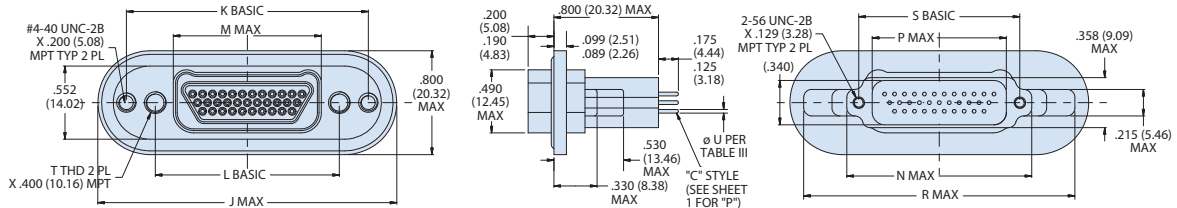

Shell Size	J Oal	K Basic	L Basic	M Max	N Max	P Max	R Max	S Basic	T Typ Unc 2-B
G	2.500 (63.50)	2.000 (50.80)	1.388 (35.26)	1.120 (28.45)	1.410 (35.81)	1.020 (25.91)	2.250 (57.15)	1.215 (30.86)	#6-32

SHELL SIZE H & L

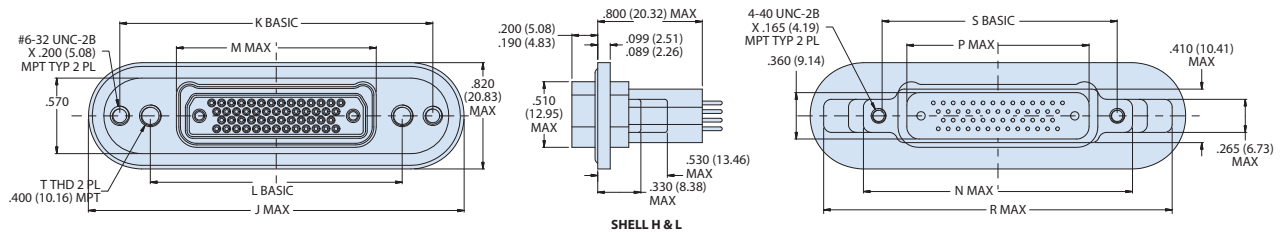

Shell Size	J Oal	K Basic	L Basic	M Max	N Max	P Max	R Max	S Basic	T Typ Unc 2-B
H	3.050 (77.47)	2.500 (63.50)	1.900 (48.26)	1.510 (38.35)	2.045 (51.94)	1.385 (35.18)	2.850 (72.39)	1.800 (45.72)	#8-32
L	3.250 (82.55)	2.700 (68.58)	2.136 (54.25)	1.740 (44.20)	2.281 (57.94)	1.625 (41.28)	3.100 (78.74)	2.036 (51.71)	#8-32

SHELL SIZE M

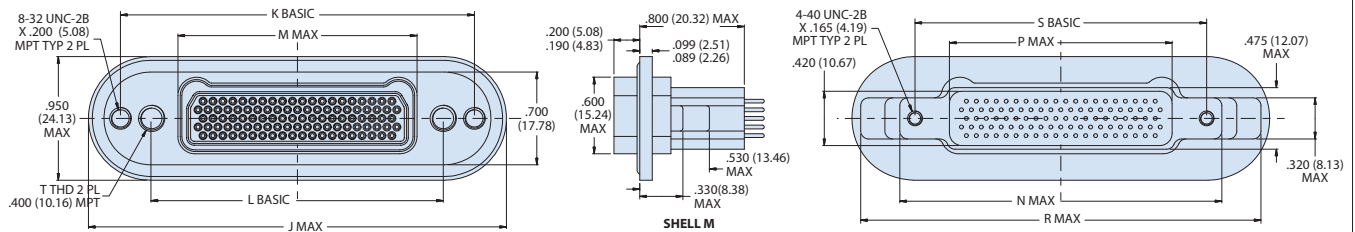

Shell Size	J Oal	K Basic	L Basic	M Max	N Max	P Max	R Max	S Basic	T Typ Unc 2-B
M	3.375 (85.73)	2.870 (72.90)	2.200 (55.88)	1.800 (45.72)	2.485 (63.12)	1.690 (42.93)	3.200 (81.28)	2.200 (55.88)	#10-32

TABLE IV

Contact Size	ϕT
23	.022 (0.56); .018 (0.46)
16	.064 (1.63); .061 (1.55)
12	.095 (2.41); .093 (2.36)
8	.182 (4.62); .178 (4.52)

791-069 Rear-Panel Mount Hermetic Receptacles,
Pin Face Scoop-Proof

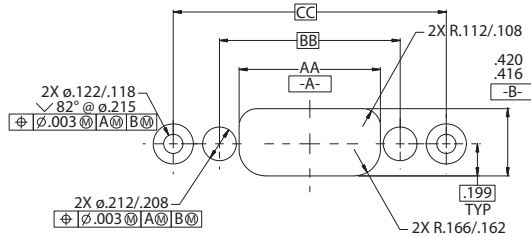

SHELL SIZES A, B, C, D, E, F, J, & K
FOR DIMENSIONS, USE TABLE IV

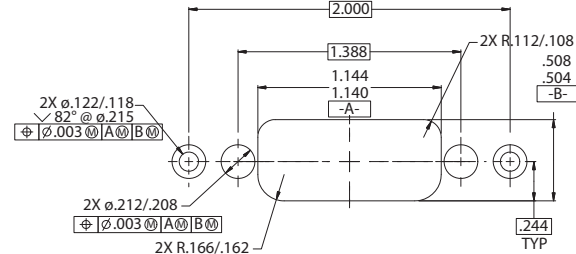

SHELL G

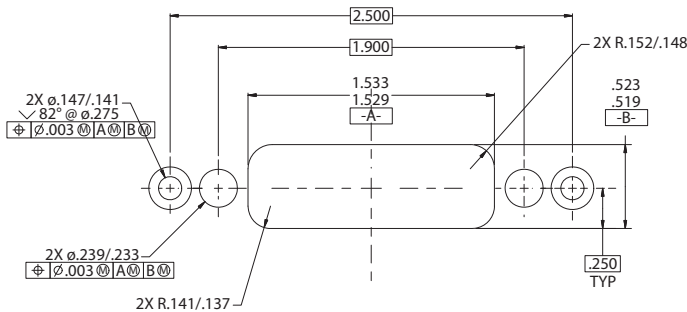

SHELL H

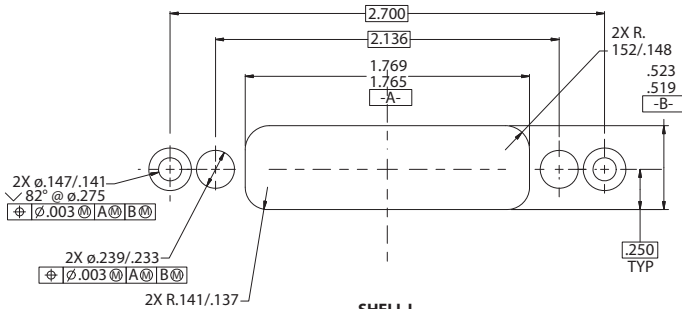

SHELL L

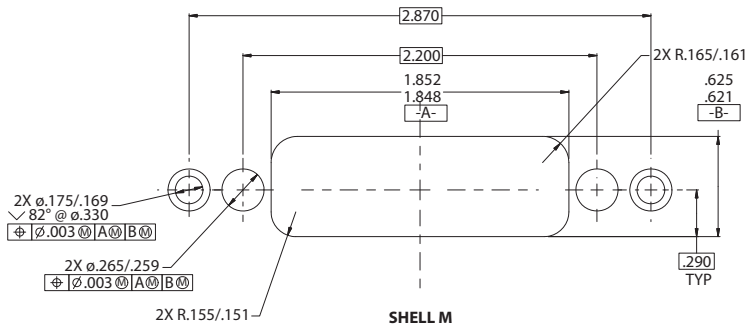

SHELL M

TABLE III			
Shell Size	AA ±.002	BB Basic	CC Basic
A	0.505 (12.83)	0.750 (19.05)	1.300 (33.02)
B	0.655 (16.64)	0.900 (22.86)	1.475 (37.47)
C	0.805 (20.45)	1.050 (26.67)	1.600 (40.64)
D	0.880 (22.35)	1.125 (28.58)	1.700 (43.18)
E	1.030 (26.16)	1.275 (32.39)	1.800 (45.72)
F	1.180 (29.97)	1.425 (36.20)	1.925 (48.90)
J	1.555 (39.50)	1.800 (45.72)	2.400 (60.96)
K	1.930 (49.02)	2.175 (55.24)	2.675 (67.94)